

TOWN AND COUNTRY PLANNING (GENERAL PERMITTED DEVELOPMENT) ORDER 1995

DIRECTION MADE UNDER ARTICLE 4 (1)

WHEREAS the Council of the District of North Devon being the appropriate local planning authority within the meaning of article 4(6) of the Town and Country Planning (General Permitted Development) Order 1995, are satisfied that it is expedient that development of the description set out in the schedule below should not be carried out on the land on the land shown edged red on the attached plan, unless permission is granted on an application made under Part 111 of the Town and Country Planning Act 1990.

NOW THEREFORE the said Council in pursuance of the power conferred on then by article 4(1) of the Town and Country Planning (General Permitted Development) Order 1995 hereby direct that the permission granted by article 3 of the said order shall not apply to the development on the said land description set out in the Schedule below.

SCHEDULE

- I. The erection, construction, maintenance, improvement or alteration of a gate fence or other means of enclosure being development comprised within Class A Part 2 of Schedule 2 to the said order and not being development comprised within any other class
- II. The formation laying out and construction of a means of access to a highway which is not a trunk road or a classified road, where that access is required in connection with development permitted by any Class in this schedule (other than Class A of this part) being development comprised within Class B Part 2 of Schedule 2 to the said order and not being development comprised within any other class.
- III. The provision on the land of buildings, moveable structures, works plant or machinery required temporarily in connection with and for the duration of operations being or to be carried out on, in, under or over the land or on land adjoining that land, being development comprised within Class A, Part 4 of Schedule 2 to the said order and not being development comprised within any other class.
- IV. The use of any land for any purpose for not more than 28 days in total in any calendar year, of which not more than 14 days in total may be for the purposes referred to in paragraph B.2, and the provision on the land of any moveable structure for the purposes of the permitted use, being development comprised within Class B Part 4 of Schedule 2 to the said order and not being development comprised within any other class.

- V. The use of the land, other than a building, as a caravan site in the circumstances referred to in paragraph A.2, being development comprised within Class A, Part 5 of Schedule 2 to the said order and not being development comprised within any other class.
- VI. The carrying out on agricultural land comprised in an agricultural unit of not less than 0.4 but less than 5 hectares in area of development consisting of
- (a) the extension or alteration of an agricultural building.
  - (b) The installation of additional or replacement plant of machinery
  - (c) the provision, rearrangement or replacement of a sewer, main, pipe, cable, or other apparatus;
  - (d) the provision, rearrangement or replacement of a private way;
  - (e) the provision of a hard surface;
  - (f) the deposit of waste; or
  - (g) the carrying out of any of the following operations in connection with the fish farming, namely, repairing ponds and raceways; the installation of grading machinery, seration equipment or flow meters and associated channel; the dredging of ponds; and the replacement of tanks and nets, where the development is reasonably necessary for the purposes of agriculture within the unit, being development comprised within Class B, Part 6 of Schedule 2 to the said order and not being development comprised within any other class.
- VII The use of the land by members of a recreational organisation for the purpose of recreation or instruction, and the erection or placing of tents on the land for the purposes of the use, being development comprised within Class A Part 27 of Schedule 2 to the said order and not being development comprised within any other class.

Given under the Common Seal of the District Council of North Devon  
this.....3rd.....day of .....March.....2005



The Common Seal of The Council was affixed to this Direction in the Presence of

.....  
Officer



..... Chief Executive

The First Secretary of State hereby approves the foregoing Direction



Signed by the authority of the Secretary of State

Date: 30 June 2005

EX37 9NG

P12 C53560  
MK's.

**N.D.D.C.**  
**PLANNING DEPT**  
- 4 OCT 2004  
FILE NO:  
RECEPTION:

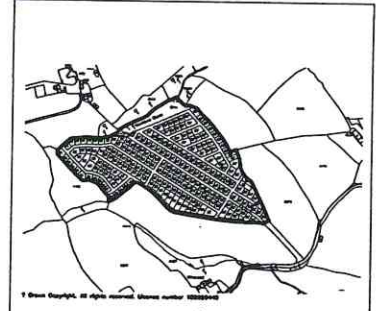
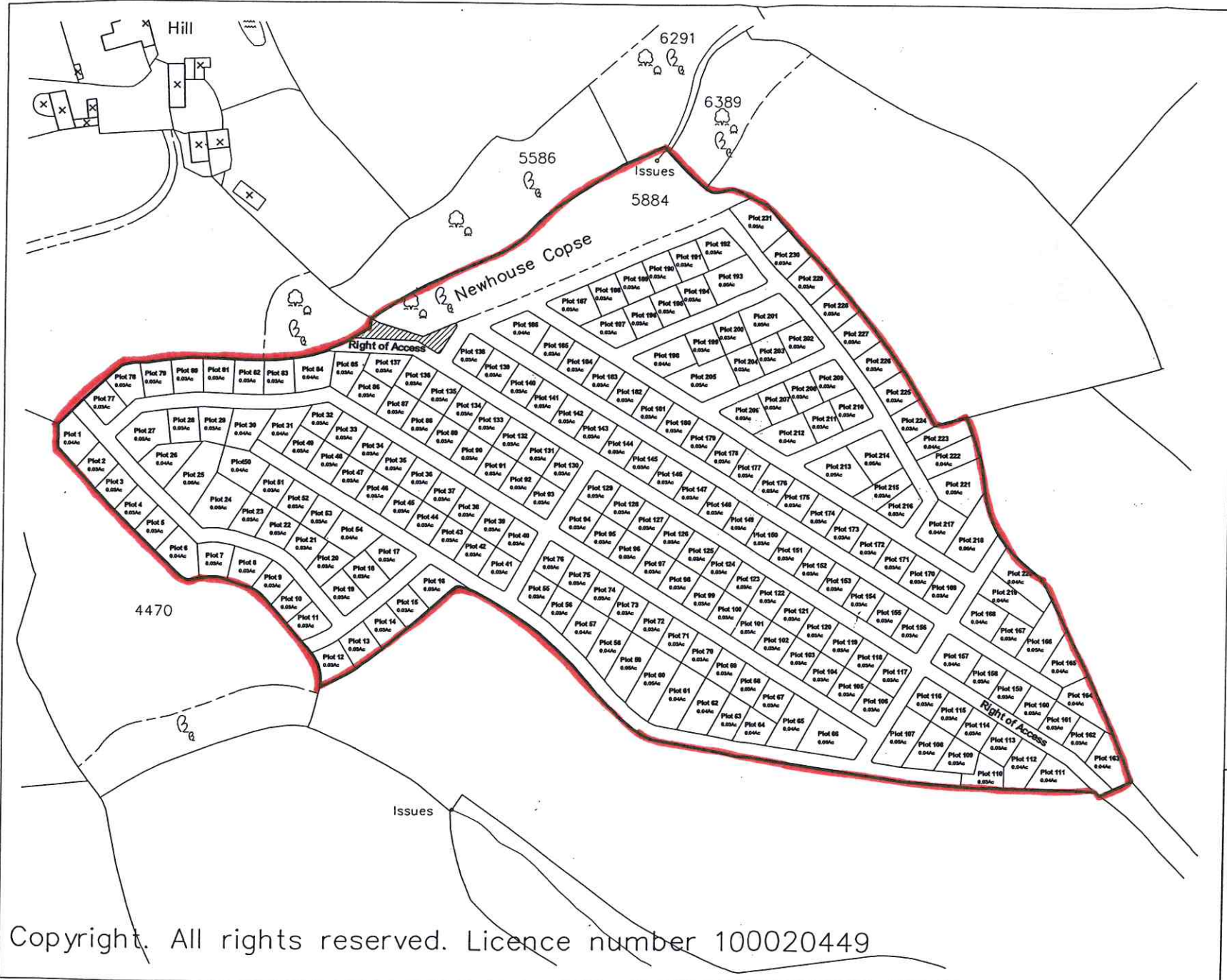

Project  
**Poole Lane, Umberleigh - Devon**

Drawing Title  
**Plot Map**

Scale  
**1:1250**

Date  
**10 Sep 04**

Drawing No  
**12462**

Project No  
**DV/ PL001**

Copyright. All rights reserved. Licence number 100020449