

North Devon Council – Local Interest Building Entry Form

Building Name / Number: Velator Memorial

Parish : Braunton

Ward : Braunton West

Address :
Caen Street
Braunton

NGR : SS 2487,1366

Entry # : BRU / 1

Date Adopted : 2012

Listing Description :

Memorial featuring a recovered iron anchor on stone and river cobble base with small wood and brass plaque inscribed:

“DEDICATED TO THE MEMORY OF BRAUNTON SAILORS WHO SAILED FROM NEARBY PORT OF VELATOR”

Area also includes 4 benches sheltered by a modern natural stone wall to the immediate west of the memorial anchor.

Within Conservation Area ? Braunton

Adj ☐

Justification For Inclusion :

- A ☐
- B ☐
- C ☐
- D ☐
- E ☐
- F ☒
- G ☐
- H ☒
- I ☐

The memorial stands as a landmark along Caen Street as well as being a portion of static space and access to the Tarka Trail (F). The memorial is a reminder of past local activities (H)

Location Map :

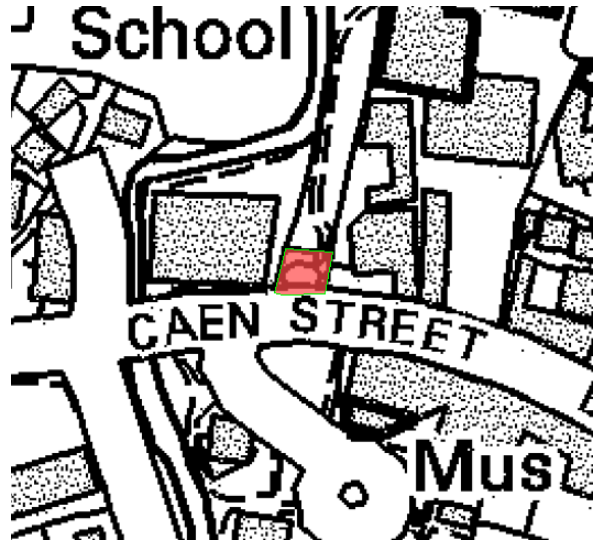
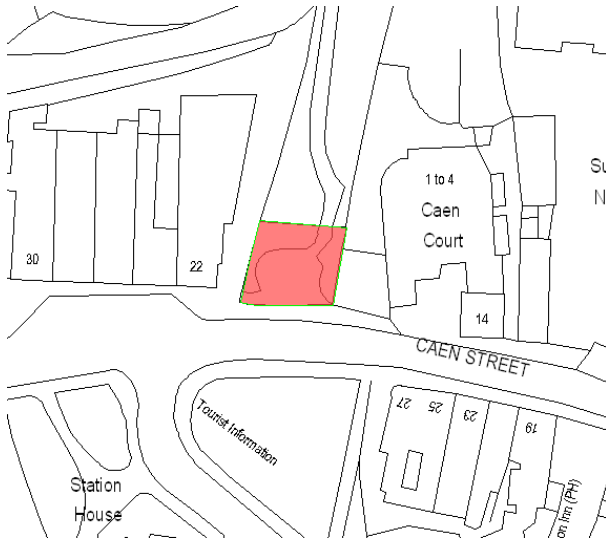

Photograph(s):



North Devon Council – Local Interest Building Entry Form

Building Name / Number:

Parish : **Ward :**

Address :

NGR : **Entry # :**

Date Adopted :

Listing Description :

Public House, former Coaching Inn, frontage remodelled in Georgian period c. 1820, rear range slightly earlier. 4 bay arrangement, upper floor has 4 no. 2 over 2 unhorned sashes, ground floor has 2 no. 2 over 8 unhorned sashes, entrance door with overlight and at right end multi light top hung casement window in recessed former opening. Cast iron guttering, natural slate roof. Frontage rendered, some elements at rear limewashed and painted rubble stone. Rear range roofed in artificial slate.

Within Conservation Area ? Adj ☐

Justification For Inclusion :

- A ☐
- B ☐
- C ☐
- D ☐
- E ☒
- F ☐
- G ☒
- H ☐
- I ☐

Inn associated with main road route through the village, but also associated with travellers arriving and departing by train (E). Caen Street once had several hotels and guest houses dependent on the arrival of tourists by train, the survival of the London Inn as a public house reflects this (G).

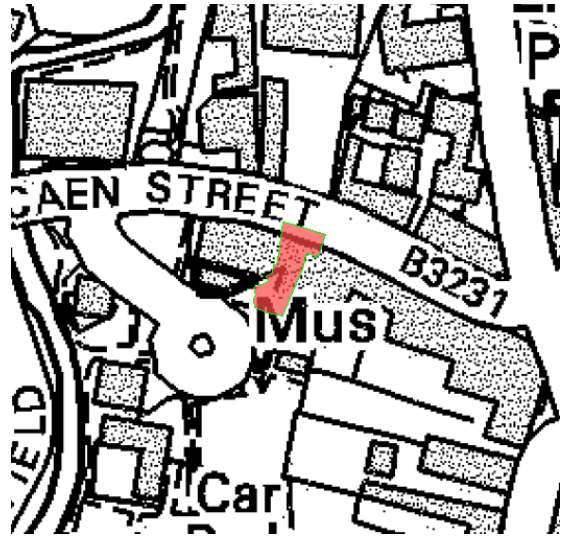

A narrow alleyway between white buildings. On the left, a white wall features a dark, shield-shaped plaque with gold lettering. A small, dark, arched doorway is visible. On the right, a wooden staircase leads up to a second floor. A yellow bush is in the foreground on the left. A small white box with the number '10' is visible in the bottom left corner.

North Devon Council – Local Interest Building Entry Form

Building Name / Number: Station House (Wensley Newsagents & The Flat)

Parish : Braunton

Ward : Braunton West

Address :
Station House, Caen Street
Braunton
EX33 1AA

NGR : SS 2487,1366

Entry # : BRU / 3

Date Adopted : 2012

Listing Description :

Former Station Master's House for Braunton Train Station, now newsagents. Previously part of a larger complex including an attached booking office now demolished.

Rendered local stone construction with natural slate roof on 'L' shaped plan. 2 storeys with steep roof pitch, 2 large brick chimneys on the ridge line. Upper floors feature round headed window reveals with sliding sash 2 over 2 windows and large stone projecting sills.

Ground floor has added canopy over newsagent's shopfront as projecting lean-to slate roof supported on timber framework and posts. Some ground floor windows have been blocked and the shopfront itself is a latter addition though broadly traditional in style.

Within Conservation Area ? Braunton

Adj ☐

Justification For Inclusion :

- A ☐
- B ☐
- C ☐
- D ☐
- E ☒
- F ☐
- G ☒
- H ☐
- I ☐

Former house associated with the rail line through the village (E). Serves as a reminder of the former rail route through the village and retains an association with the Tarka Trail which follows the old rail route (G).

Location Map :

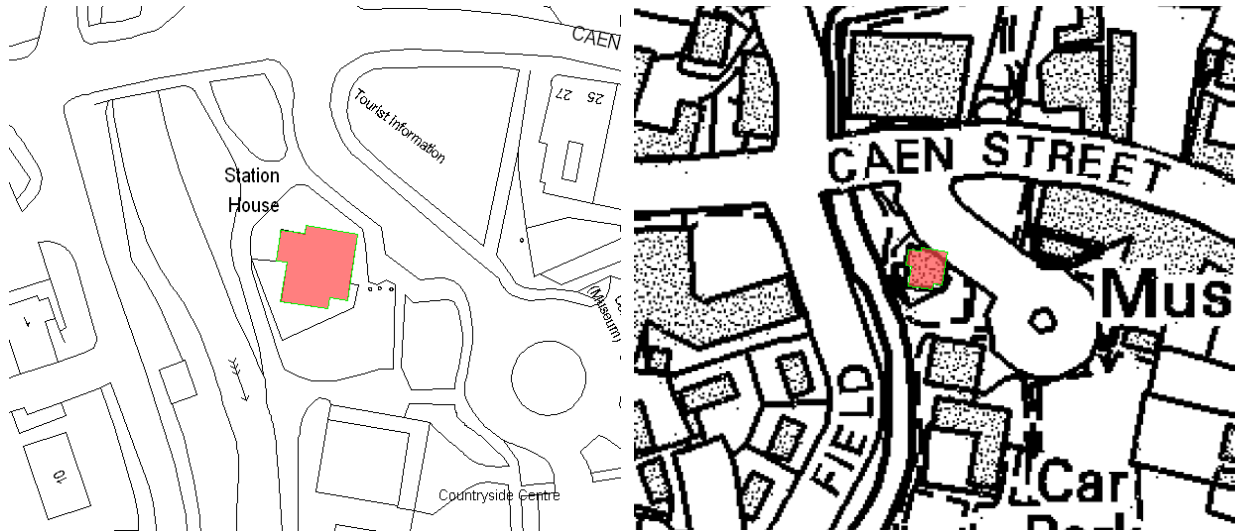

Photograph(s):



North Devon Council – Local Interest Building Entry Form

Building Name / Number: The Elliot Gallery (former chapel)

Parish : Braunton

Ward : Braunton East

Address :
Hills View
Braunton
EX33 2LA

NGR : SS 2487,1366

Entry # : BRU / 4

Date Adopted : 2012

Listing Description :

Former non-conformist chapel, grave-yard remains to North West, now art gallery.
Mixed materials, exposed, dressed local stone with bath stone quoins as a plinth with incised render above. Main entrance door is a heavily recessed round arched opening executed in corbled courses of marland brick, single storey. Memorial 'donation' stones are set into the rendered section and inscribed with names of donors.
Natural slate roof with decorative clay ridge tiles and clay breather tiles near the ridge line. Red brick chimneys. Windows are heavily mullioned with top hung opening top lights.
Two storey section at North West end may have been the manse, in similar style although windows feature stained glass elements as decoration.

Within Conservation Area ? Braunton

Adj ☐

Justification For Inclusion :

- A ☐
- B ☒
- C ☐
- D ☐
- E ☐
- F ☐
- G ☐
- H ☒
- I ☐

Former chapel associated with the religious revival experienced in England during the Victorian period and the growth of non-conformist religion (H). The building features the incised render found on many properties, including some listed properties, within Braunton (B).

Location Map :



Photograph(s):



North Devon Council – Local Interest Building Entry Form

Building Name / Number: Masonic Hall

Parish : Braunton **Ward :** Braunton East

Address :
Ilfracombe Road
Braunton
EX33 2ER

NGR : SS 2488,1372 **Entry # :** BRU / 5

Date Adopted : 2012

Listing Description :

Masonic Hall, rectangular plan with apsidal projection at East end. Flat roof behind parapet walls.
Roadside elevation decorated with doorway and projecting render relief in Art Deco style. Wide timber double doors in recess flanked by octagonal pillars topped with shallow fluted bronze byres. Above the doorway a full height narrow window, metal framed, vertically sub divided with mix of fixed and opening lights. Projecting plaster decoration around and above window, corbelling in above with the Masonic dividers and square symbol within a cartouche projecting slightly above the parapet wall.
4 tall slit windows along the long sides of the building, each have corbelled in heads as a decorative feature.

Within Conservation Area ? Braunton Adj ☐

Justification For Inclusion :

- | | | |
|---|-------------------------------------|---|
| A | <input type="checkbox"/> | Association with the local branch of the Freemasons movement (H). Together with buildings along Exeter Road this building is constructed in the Art Deco style typical of the 1920's and the period in which major highways realignments were being carried out in Braunton (D) |
| B | <input type="checkbox"/> | |
| C | <input type="checkbox"/> | |
| D | <input checked="" type="checkbox"/> | |
| E | <input type="checkbox"/> | |
| F | <input type="checkbox"/> | |
| G | <input type="checkbox"/> | |
| H | <input checked="" type="checkbox"/> | |
| I | <input type="checkbox"/> | |

Location Map :

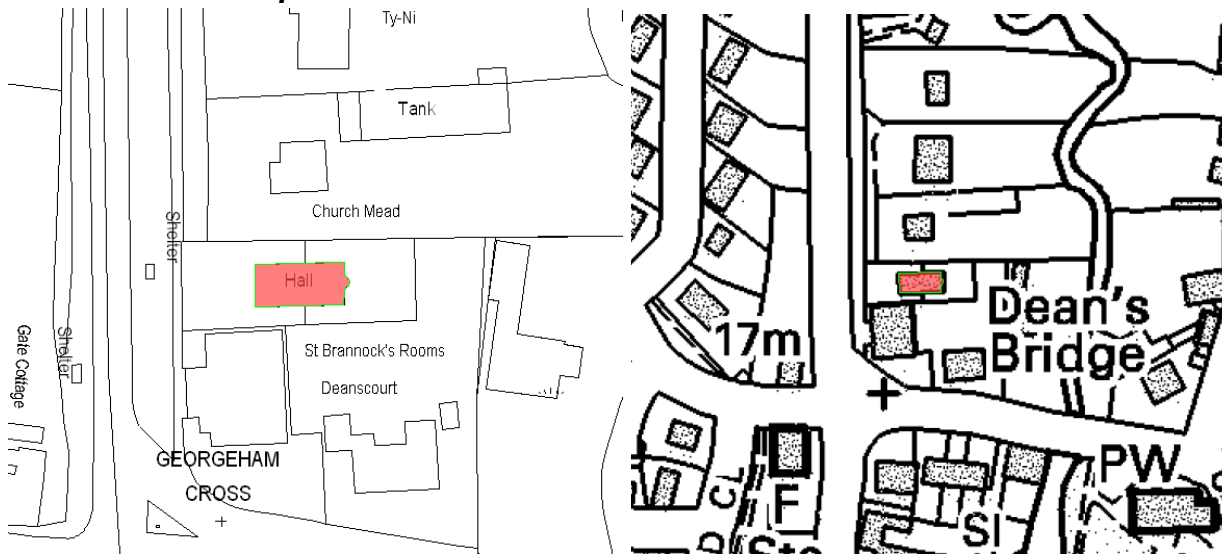

Photograph(s):



North Devon Council – Local Interest Building Entry Form

Building Name / Number:

Parish : **Ward :**

Address :

NGR : **Entry # :**

Date Adopted :

Listing Description :

Built in 1854 as Challoners School with money raised by the Trustees of Braunton as a Free School, and began charging a fee in 1890 when funds began to dwindle. Now in use as the village fire station. Of coursed local shale-stone with beer stone dressings to window reveals, windows are mullion and transom elements arranged as a series of round headed lancets grouped as a set of two or three within a large round headed window reveal. Decorative punched barge boards as well as a small timber clad entrance porch with lean too roof. Roofs are of natural slate with cast iron gutters. Multiple receiver and transmitter aerials associated with the fire service use.

Within Conservation Area ? Adj ☐

Justification For Inclusion :

- A ☐
- B ☐
- C ☐
- D ☐
- E ☒
- F ☒
- G ☐
- H ☐
- I ☐

Associated with several streets within the village through the first Headmaster of the school; Mr. J.L. 'Cavie' Ralph (ie. Cavie Road and Cavie Crescent) (E), The building has landmark quality thanks to its design and its position at the crossroads on the northern approach to the village (F).

Location Map :



Photograph(s):



North Devon Council – Local Interest Building Entry Form

Building Name / Number: Fullabrook Mill

Parish : Braunton **Ward :** Braunton East

Address :
Braunton
EX33 2NJ

NGR : SS 2514,1402 **Entry # :** BRU / 7

Date Adopted : 2012

Listing Description :

Former water powered mill, 2 storey, probably mid 18th Century with early 19th Century remodelling. Exposed dressed and rough coursed rubble stone construction, natural slate roofs with red clay tile ridges. Various window styles, including 4 pane per light twin light casements, 1 over 1 horned sashes and 1 over 1 replacement top hung casements. T shaped plan with central forward gabled projection. Metal disc end plated to tie bars visible at first floor level. Upper floor window nearest the road appears reduced and may have previously been a loading door. East end was former mill workings and warehousing, including raised platform with open arches to front, near the position of the wheel pit which also survives. Glazed single storey extension to west end incorporating fragments of surviving historic walls. Former mill leat to bring water from nearby river and pond no longer in use.

Within Conservation Area ? ☐ Adj ☐

Justification For Inclusion :

- A ☐
- B ☒
- C ☐
- D ☐
- E ☐
- F ☐
- G ☒
- H ☐
- I ☒

Survival of a recognisable mill building serves as a reminder of the widespread nature of water power within Braunton Parish and the wider area of Devon scattered with multiple river valleys (G+B) and its presence contributes to the character of the valley within which it is situated (I).

Location Map :

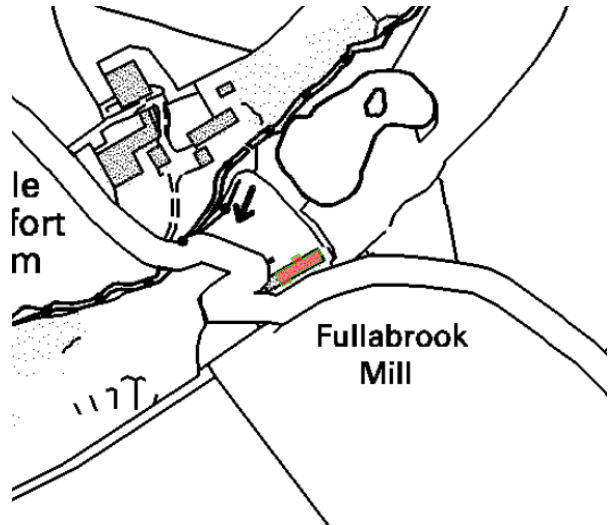
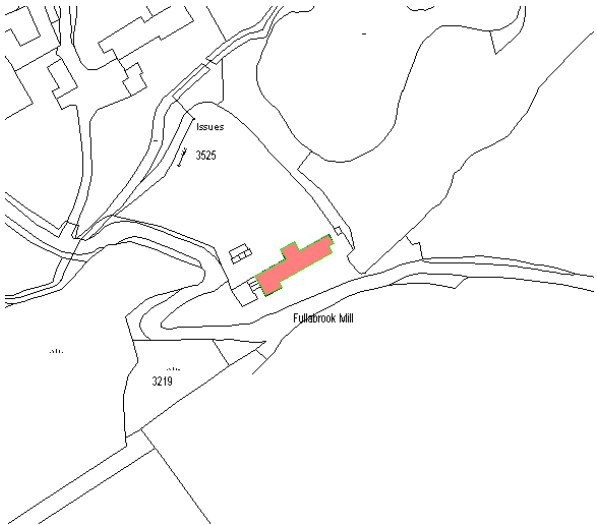

Photograph(s):

09/12/2010



09/12/2010



North Devon Council – Local Interest Building Entry Form

Building Name / Number:

Parish : **Ward :**

Address :

NGR : **Entry # :**

Date Adopted :

Listing Description :

Toll House, still in active use as such. Rendered rubble stone construction, some lean-to additions are heavily whitewashed and rear gabled range is in exposed stone. Natural slate roof (modern replacement with roof void breather vents) with blue clay ridge tiles. Large three light casement window (2 panes per light) on ground floor gives views onto the road near the toll gate; other windows are twin light (2 panes per light) side hung casements and one top hung 1 over 1 casement example on the south side. Projecting porch with half canopy over one ground floor window. Single gable end brick chimney flue stack with simple clay pot.

Within Conservation Area ? Adj ☐

Justification For Inclusion :

- A ☐
- B ☐
- C ☐
- D ☒
- E ☒
- F ☐
- G ☐
- H ☐
- I ☐

Association with the private toll road to Crow Point which remains as one of North Devon's few remaining toll roads (E). It is also a reminder of the private turnpike road trusts which allowed for significant improvements in roads during the mid to late 18th Century and the associated toll infrastructure (D).

Location Map :

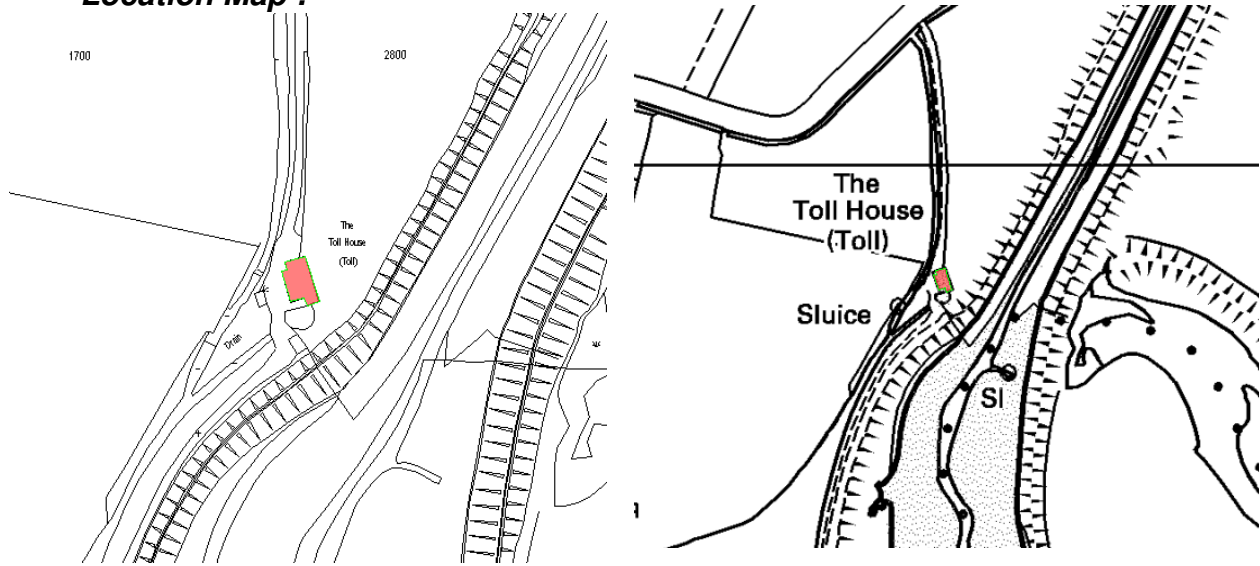

Photograph(s):



North Devon Council – Local Interest Building Entry Form

Building Name / Number: Museum of British Surfing & Youth Centre

Parish : Braunton

Ward : Braunton West

Address :
Caen Street
Braunton
EX33 1AA

NGR : SS 2487,1365

Entry # : BRU / 9

Date Adopted : 2012

Listing Description :

Former railway engine shed, now Museum of British Surfing and Youth Centre. Original building of exposed local stone, squared and dressed and laid as random rubble. Natural slate pitched and gabled roof. Main doors represent a partial reduction of a large sliding double door arrangement. Top slider rail remains while the upper portion of the opening is boarded over in timber and the lower section is a pair of modern glazed doors, with timber outer doors which close to create the illusion of large sliding doors as would have originally been present. Single window opening on South side, large round headed fixed metal frame. Building is extended to North and to rear with a low range featuring a pitched and hipped roof, also in slate, rendered and white painted walls, windows have metal shutter blinds. Rear of building has painted murals.

Within Conservation Area ? Braunton

Adj ☐

Justification For Inclusion :

- A ☐
- B ☐
- C ☐
- D ☒
- E ☒
- F ☐
- G ☐
- H ☐
- I ☐

Association with the former Ilfracombe to Barnstaple line from its initial function as an engine shed (E). Reminder of the expansion of Railway infrastructure during the 19th century (D). Its continued use contributes to the character of the surrounding area (I).

Location Map :

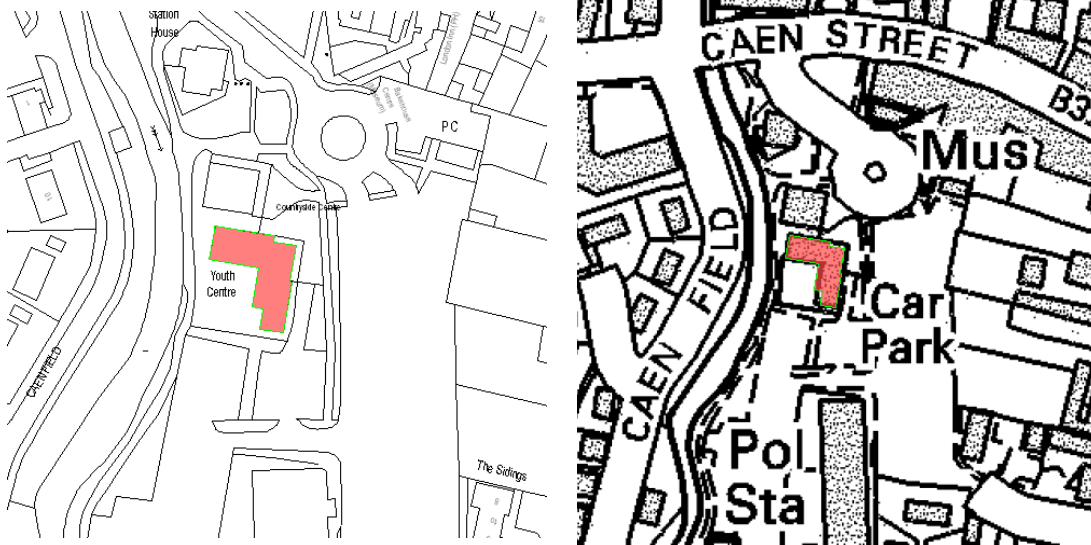

Photograph(s):

